

**FISHER & PAYKEL**

**INTEGRATED  
REFRIGERATOR FREEZER**

---

RB60V18 & RB60V18M

**INSTALLATION GUIDE / USER GUIDE**  
**NZ AU UK IE EU HK IN SG**



## CONTENTS

---

Safety and warnings	4
Installation instructions — general	7
Installation instructions — refrigerator	8
Moving or storing your refrigerator	28
Operating instructions	29
Interior features	34
Maintenance	36
Cleaning care — interior/exterior	37
Storing food in your refrigerator	38
Storing food in your refrigerator compartment and variable-temperature drawer	39
Storing food in your freezer	41
Troubleshooting	43
Wiring diagram	45
Manufacturer's warranty — NZ AU GB IE EU HK IN SG	46
Customer care — NZ AU GB IE EU HK IN SG	48
Customer care — CN	50
European directive 2012/19/EU on Waste Electrical and Electronic Equipment (WEEE)	51

---

### Registration

To register your product visit our website: [fisherpaykel.com/register](http://fisherpaykel.com/register)

### **WARNING!**



#### **Electric Shock Hazard**

Failure to do so can result in death, electric shock, fire or injury to persons.

- Read and follow the safety and warnings outlined in this user guide before operating this appliance.

### **WARNING!**



#### **Risk of fire/flammable material**

This refrigerator contains flammable refrigerant isobutane (R600a).

## READ AND SAVE THIS GUIDE

Use this appliance only for the intended purpose as described in the user guide.

When using this appliance always exercise basic safety precautions including the following:

- This product has been designed for use in a normal domestic (residential) environment.
- Children aged 3 to 8 years may load and unload this appliance under supervision.
- This appliance is not intended for use by persons (including children under the age of 8 years) with reduced physical, sensory or mental capabilities, or lack of experience and knowledge, unless they have been given supervision or instruction concerning use of the appliance by a person responsible for their safety. Cleaning and user maintenance shall not be made by children without supervision.
- Young children should be supervised to ensure they do not play with the appliance.
- The manufacturer's installation instructions for product and cabinetry ventilation must be followed when installing the appliance.
- To avoid hazard due to instability of the appliance, it must be fixed in accordance with installation instructions.
- Keep ventilation openings, in the appliance enclosure or in the built-in structure, clear of obstruction.
- Do not use mechanical devices or other means to accelerate the defrosting process.
- Do not damage the refrigerant circuit.
- In case of damage to the refrigerant circuit, ventilate the area by opening all windows. Do not operate electrical equipment or any other equipment that may produce arcs, sparks or flames in the area. Contact your Fisher & Paykel trained and supported service technician immediately to arrange for the appliance to be repaired.
- It is hazardous for anyone other than an authorised service person to service this appliance. In Queensland the authorised service person must hold a gas work licence or authorisation for hydrocarbon refrigerants to carry out service or repairs which involve removal of covers.

## **SAFETY AND WARNINGS**

---

### **Electrical**

- This appliance must be installed in accordance with the installation instructions before use.
- To allow disconnection of the appliance from the supply after installation, incorporate a switch in the fixed wiring in accordance with the wiring rules.
- Never unplug your refrigerator by pulling on the power cord. Always grip the plug firmly and pull straight out from the outlet.
- Do not plug in any other appliance at the same power point as your refrigerator or use extension cords or double adapters.
- Repair or replace immediately all electric service cords that have become frayed or otherwise damaged. Do not use a cord that shows cracks or abrasion along its length or at either the plug or appliance end.
- If the power supply cord is damaged, it must only be replaced by your Fisher & Paykel trained and supported service technician because special purpose tools are required.
- When moving your appliance away from the wall, be careful not to roll over or damage the power cord.
- Do not use electrical appliances inside the food storage compartments of the appliance.
- When positioning the appliance, ensure the power cord is not trapped or damaged.
- Do not locate multiple portable socket-outlets or portable power supplies at the rear of the appliance.

### **Servicing**

- Your refrigerator is designed to operate for many years without the need for service checks. However, if your refrigerator is malfunctioning, have it attended to by your Fisher & Paykel trained and supported service technician as soon as possible. All electrical repairs must be carried out by an adequately trained service technician or qualified electrician.
- It is hazardous for anyone other than a Fisher & Paykel trained and supported service technician to service this appliance.

### **Food safety**

- Regularly clean surfaces that come into contact with food.
- Ensure any raw meat or fish is stored in sealed containers to prevent cross-contamination.
- To avoid contamination of food; Do not open the door for long periods as it can cause a significant increase of the temperature in the compartments of the appliance.
- If the appliance will be left empty for long periods, switch off, defrost, clean, dry, and leave the door open to prevent mould developing within the appliance.
- Opening the door for long periods can cause a significant increase of the temperature in the compartments of the appliance.

### **Cleaning**

- Many commercially available cleaning products contain solvents that may attack the plastic components of your refrigerator and cause them to crack.
- Avoid using anti-bacterial cleaning products on either the interior or exterior of the cabinet as they may cause rusting of metal components and cracking of plastic components.
- Please refer to the 'Cleaning care' section of this user guide for further information.

## SAFETY AND WARNINGS

---

### Disposal

- Extreme care must be taken when disposing of your old appliance to avoid hazards:
  - The flammable refrigerant gas must be safely removed.
  - The thermal insulation foam in this appliance contains flammable insulation blowing gases, any exposed foam may be highly flammable and must be carefully treated during disposal.
  - The doors and panels should be removed and the shelves left in place so that children may not easily climb inside.
- Your Fisher & Paykel trained and supported service technician will be able to give advice on environmentally friendly methods of disposing of your old refrigerator or freezer.

### Storing food and drinks

- Do not store explosive substances such as aerosol cans with a flammable propellant in this appliance.
- Never store volatile or flammable materials in your refrigerator as they may explode.
- Never freeze liquids in glass containers. Liquid expands during freezing, which may cause the container to explode.
- Never freeze carbonated drinks. They may explode.
- Do not consume food if it is too cold. Food removed from the freezer compartment may be cold enough to cause damage when brought into contact with bare skin, eg frozen ice cubes.

### Power failure — food safety

- Do not refreeze frozen foods that have thawed completely. The food may be dangerous to eat. Follow the recommendations below if you discover food in your freezer has thawed:
  - Ice crystals still visible—food may be refrozen but should be stored for a shorter period than recommended.
  - Thawed but refrigerator cold—refreezing generally not recommended. Fruits and some cooked food can be refrozen but use as soon as possible. Meat, fish, poultry—use immediately or cook then refreeze. Vegetables—discard as they usually go limp and soggy.
  - Thawed and warmer than 5°C—discard all food.

### Light source information

- This product contains a light source of energy efficiency class G. The light source used in this appliance is not suitable for room illumination.

# INSTALLATION INSTRUCTIONS — GENERAL

Please follow the steps for installation to ensure your appliance operates correctly.

## Location

Your refrigerator should not be located in direct sunlight or next to any heat generating appliance such as a cooktop, oven or dishwasher.

This refrigerating appliance is intended to be used at ambient temperatures ranging from 16 °C to 43 °C. The product performance may be compromised when operating outside of this temperature range.

## Power

To ensure that the appliance is not accidentally switched off, connect your refrigerator to its own power point. Do not plug in any other appliance at this power point or use extension cords and double adaptors, as the combined weight of both power cords can pull the double adaptor from a wall outlet socket.

For power requirements, refer to the information on the serial plate located inside the refrigerator compartment.

It is essential that the appliance be properly grounded (earthed).

## Energy saving tips

There are many simple things that can be done to save energy.

### During installation

Locate refrigerator to the coolest part of the room. Avoid areas of direct sunlight, or near heating ducts, registers, or other heat producing appliances.

Ensure your refrigerator has adequate ventilation as shown in the installation instructions.

### During use

Avoid overcrowding shelves, as this reduces airflow.

Do not use anything (such as aluminium foil, wax paper, or paper towelling) as a shelf liner, as this reduces airflow.

Avoid loading too much warm food in at once and allow good clearances in front of the air ducts within the cabinet for maximum cold air distribution.

Your refrigerator is most efficient when it is two thirds full.

Do not leave the door open for any longer than is necessary and organise items in the refrigerator to reduce the time that the door is open.

For storage of general household foods in the most efficient manner, it is recommended to use the product in the factory configuration supplied. Moving the shelves and bins will have a minimal impact on efficiency.

## Before placing food in the fresh food or freezer compartments

Remove all packaging found inside the compartments eg tape, polystyrene etc.

Clean the inside of the appliance with a mixture of warm water and a little liquid detergent to remove manufacturing and transportation dust.

The appliance may have an odour on its initial operation, but this will go when the refrigerator has cooled sufficiently.

Allow the refrigerator to run empty for 2 – 3 hours to allow each compartment to cool to the appropriate temperature.

# INSTALLATION INSTRUCTIONS – REFRIGERATOR

## Components list – Refrigerator installation

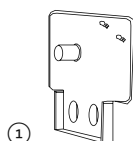

① Clearance adjustment plate  
H0060212285  
(4)

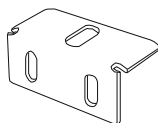

② Bottom attachment bracket  
H0060106782  
(4)

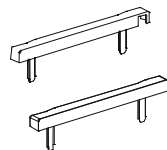

③ Top attachment bracket cover  
H0060222453  
(2 installed)

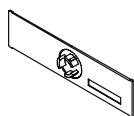

④ Hinge cover  
(4 installed)

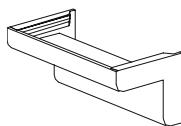

⑤ Bottom attachment  
bracket cover  
H0060210289  
(4)

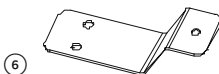

⑥ Upper fastenings  
H0060113353  
(2)

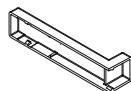

⑦ Cabinet attachment  
bracket cover  
H0060222991  
(1)

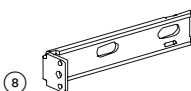

⑧ Cabinet attachment bracket  
H0060113352  
(1)

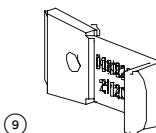

⑨ Position adjustment plate  
H0060222989  
(1)

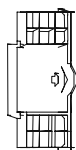

⑩ Door gasket baffle  
H0060223016  
(2 installed)



⑪ Wood screw  
0130100516  
(32)



⑫ Bottom attachment  
bracket screw  
0060802014  
(4)

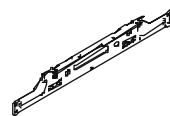

⑬ Top attachment bracket  
H0060210200  
(2 installed)



⑭ Top attachment ruler  
H0060817710  
(2 installed)

15mm to 18mm kitchen cabinet thickness can be used.



# INSTALLATION INSTRUCTIONS – REFRIGERATOR

## Exploded view

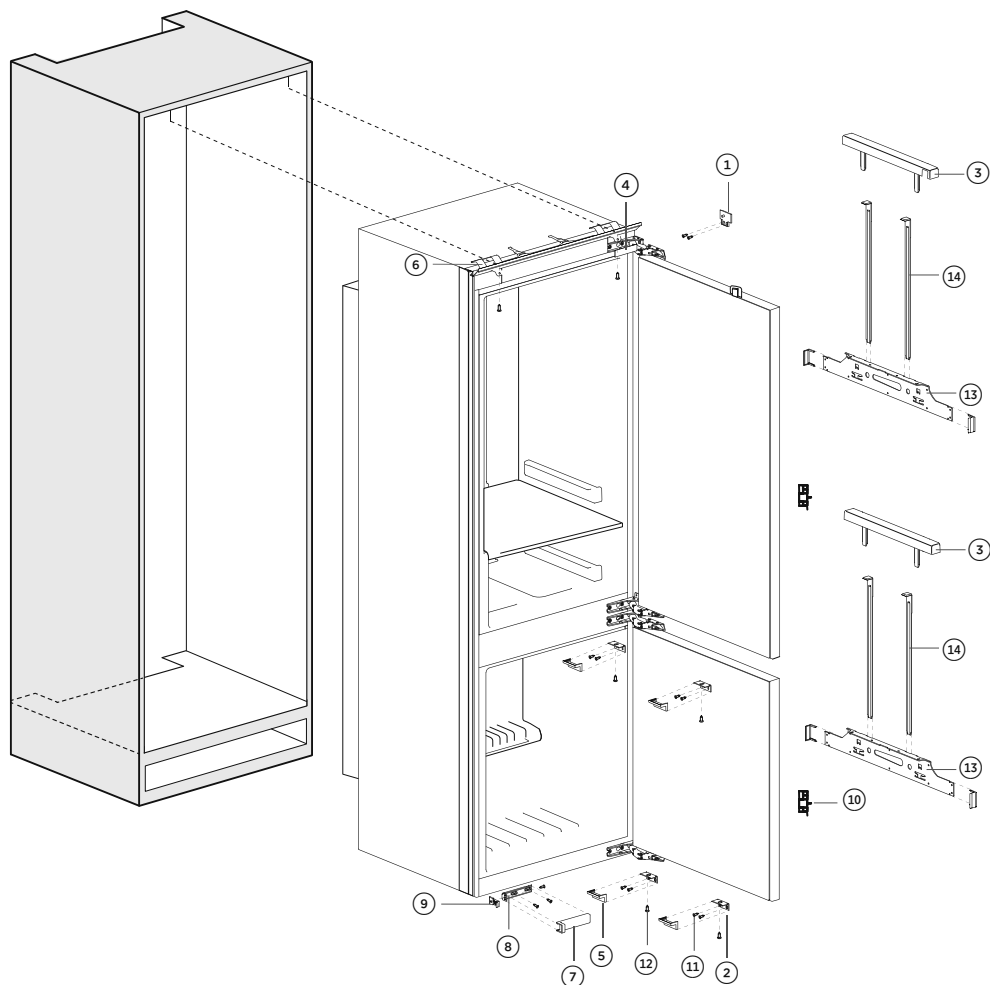

# INSTALLATION INSTRUCTIONS – REFRIGERATOR

## Product dimensions

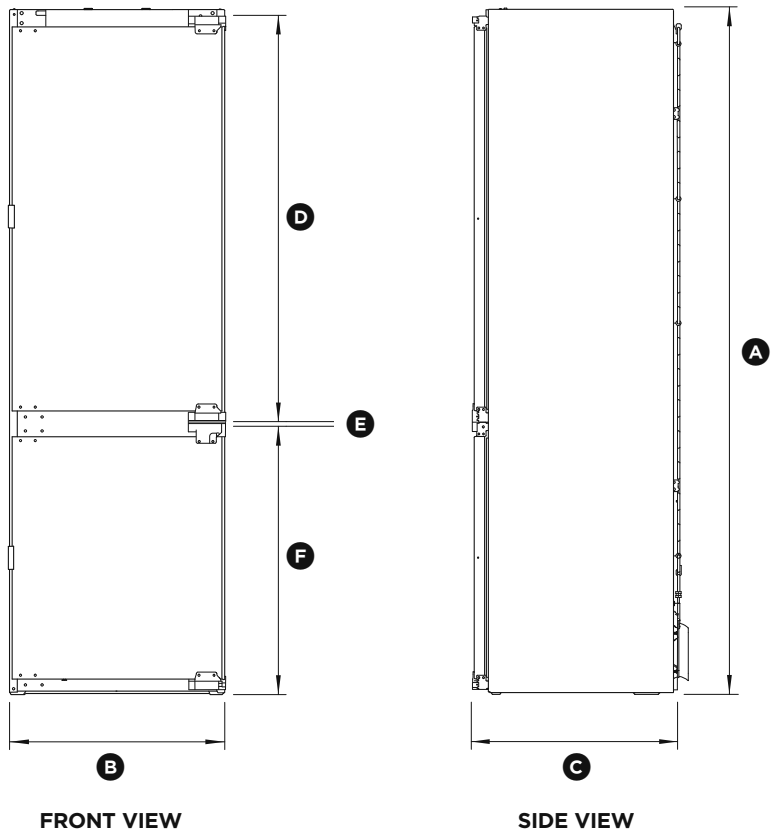

PRODUCT DIMENSIONS		mm
(A)	Overall height	1773
(B)	Overall width	555
(C)	Overall depth	540
(D)	Top door height	1066
(E)	Hinge gap height	12
(F)	Bottom door height	692

# INSTALLATION INSTRUCTIONS – REFRIGERATOR

## Cabinetry dimensions

The top of the cabinet needs to be vented into the room.

There should be enough space at the rear of the cabinet to allow cool air to be drawn over the condenser.

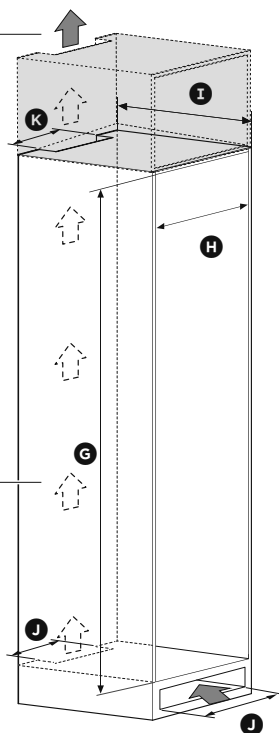

CABINETRY DIMENSIONS (including minimum clearances)		mm
Ⓒ	Inside height	1782 – 1786
Ⓗ	Inside width	564 – 570
Ⓘ	Overall depth	min. 550
MINIMUM CLEARANCES		cm <sup>2</sup>
Ⓙ	Minimum inlet vent area	200cm <sup>2</sup>
Ⓚ	Minimum outlet vent area	280cm <sup>2</sup>

# INSTALLATION INSTRUCTIONS – REFRIGERATOR

## 1. Preparations before installation

### ① Door hinge

This model is right-hand hinged, with a left-hand door opening. If required, you can change this model to left-hand hinged and right-hand door opening.

- To do this, use a flat-head screwdriver to remove the covers to the left and right of the control panel.
- Lever the left and right hand covers from the outer edge (A) as levering from the inner edge may cause damage to the trim and the control panel.
- Lever the hinge cover from the inner edge (B).

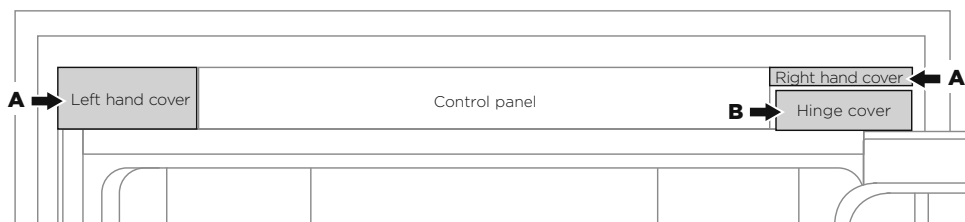
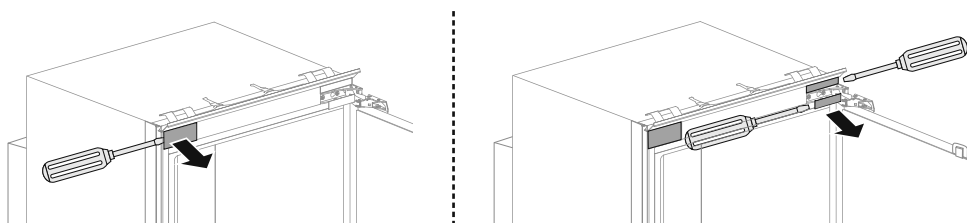

- Remove the upper and lower hinges (C) and refit them to the opposite side.

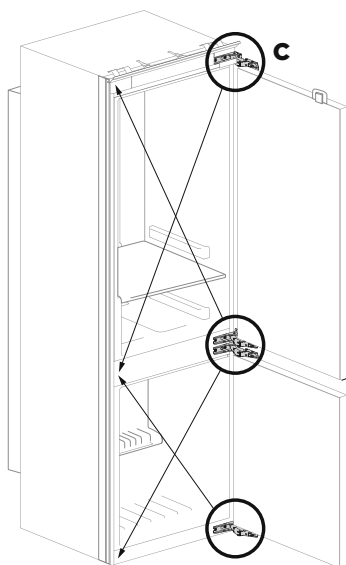

## ② Clearance adjustment plate/sheet

- If 18mm cabinet is used, clearance adjusting plate is not needed.
- If 15mm cabinet is used, clearance adjusting plate is needed.

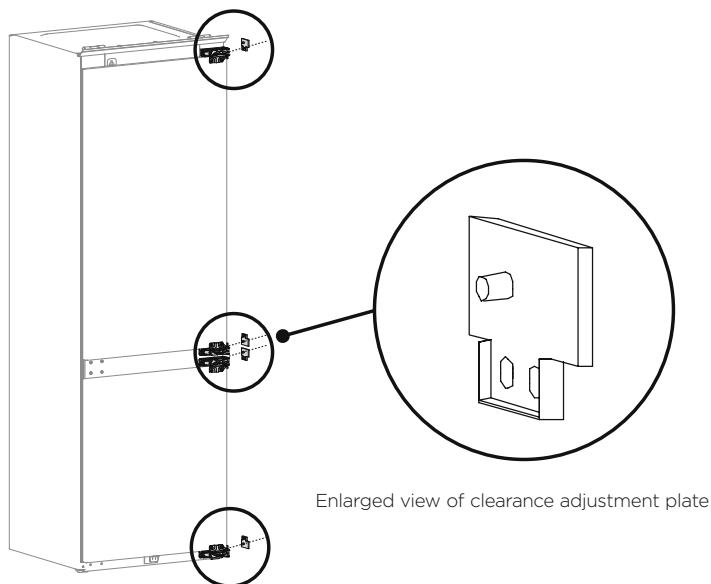

## ③ Cabinet attachment bracket and clearance adjustment plate

Fix the cabinet attachment bracket to the refrigerator with the screws provided. Then lock the clearance adjustment plate to the left side of the cabinet attachment bracket.



Installation of cabinet attachment bracket and clearance adjustment plate

### ④ Air flow stops

The air flow stops are located on the back cover of the compressor. Adjust these air flow stops to ensure they make contact with the cabinet.

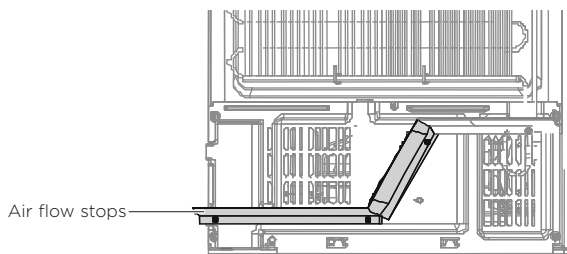

Adjusting the air flow stops

### ⑤ Door gasket baffle

Remove the door gasket baffle from the door and then store for future transportation.

## 2. Placing the refrigerator into the cabinet

- ① Pull the power cord through the hole at the back of the cabinet or if the power socket is inside the cabinet, plug in the refrigerator before installing it into the cabinet.
  - Take care not to kink or bend the power cord as a damaged cord is a fire risk.
  - For safety reasons, only turn on the refrigerator once installation is complete.
- ② Move the refrigerator into the cabinet and adjust its position to ensure that the clearance adjustment plate is attached to the bottom end of the cupboard side panel and the door gasket is attached to the front end of the cupboard side panel.

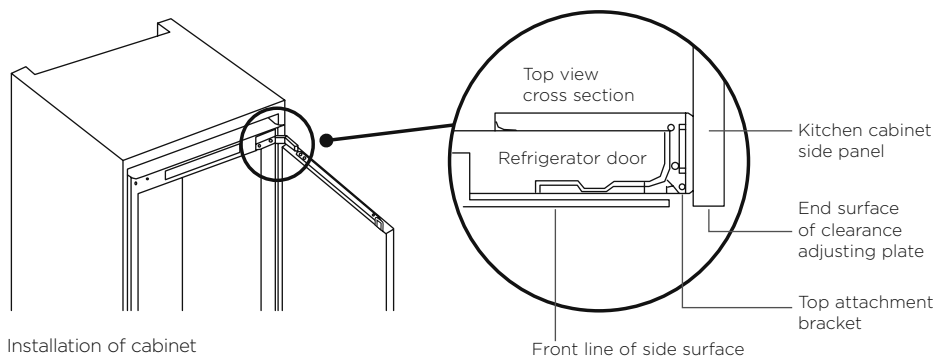

- ③ Make sure the left and right side clearances between the refrigerator and cabinet are the same.
- ④ Fasten the side surfaces of the hinge with screws. Fix one screw to the top hinge and one screw to the bottom hinge. Then fix all other screws to the remaining hinges.

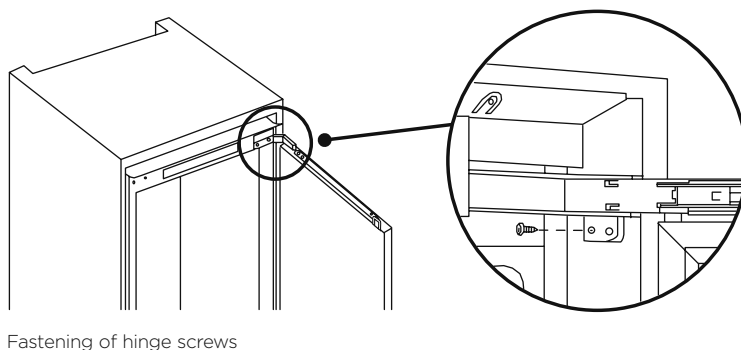

# INSTALLATION INSTRUCTIONS – REFRIGERATOR

## 3. Dismantling the top attachment brackets

- ① Open the refrigerator door and remove the top attachment bracket cover by drawing it upwards. Do the same for the freezer.
- ② Move the rulers vertically so the top of the rulers latch onto the cabinet above.
- ③ Loosen the two hexagonal nuts on the top attachment bracket (A) and then remove the top attachment bracket and rulers together. Do the same for the freezer door.
  - Both attachment brackets are required for refrigerator installation. Go to page 17 if you are now installing the refrigerator. If you do not intend to install the refrigerator at this time, store the brackets for later use.

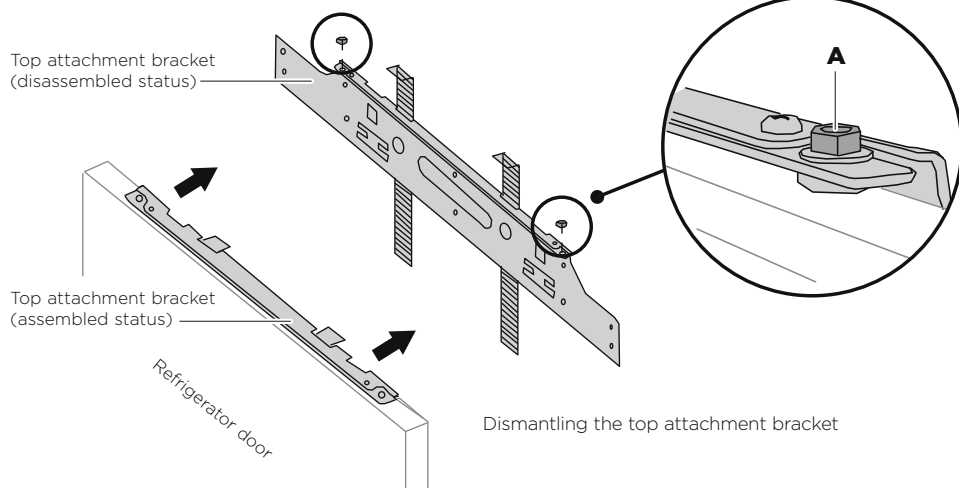
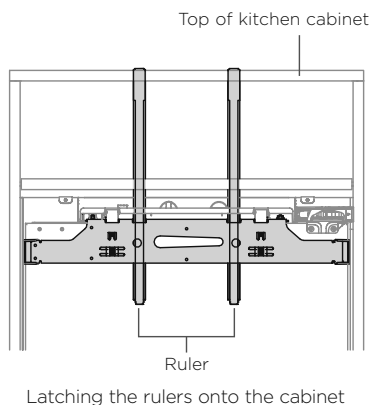

**Do not remove the door magnet.**

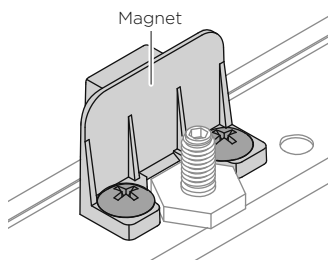



## 4. Attaching the top attachment bracket to the upper cabinet door

- ① Lay the upper cabinet door (face down) onto a clean floor.
- ② Attach the top attachment bracket to the top of the cabinet door.
- ③ Adjust to ensure the centre line of the top attachment bracket aligns with the centre of the cabinet door. The rulers should latch onto the top of the cabinet door.
- ④ Once aligned, screw the wood screws in to attach the top attachment bracket to the cabinet door.
- ⑤ Pull out the rulers on the top attachment bracket.

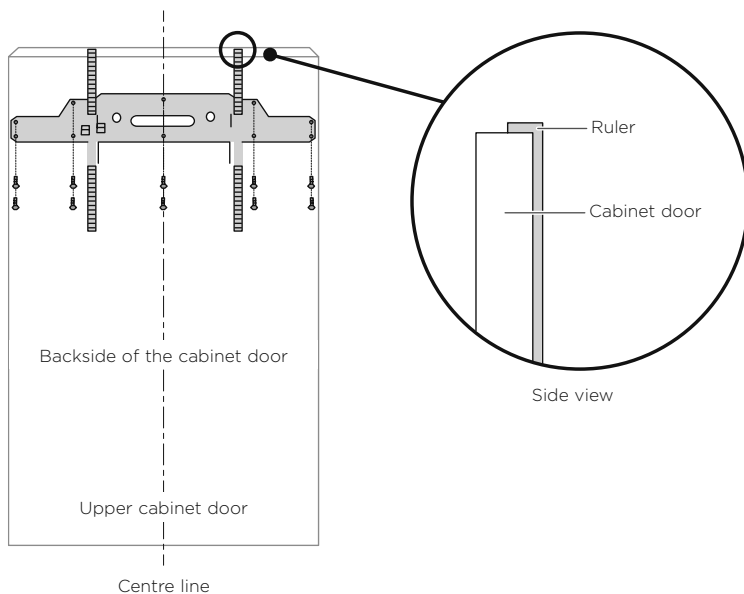

Attaching the top attachment bracket to the upper cabinet door

## 5. Attaching the upper cabinet door

- ① Open the refrigerator door, hang the upper cabinet door onto the height adjustment screws (at the upper sides of the refrigerator) and fix with hex screws.
  - Do not fasten the screws too tightly as to allow for some horizontal movement of the cabinet door.

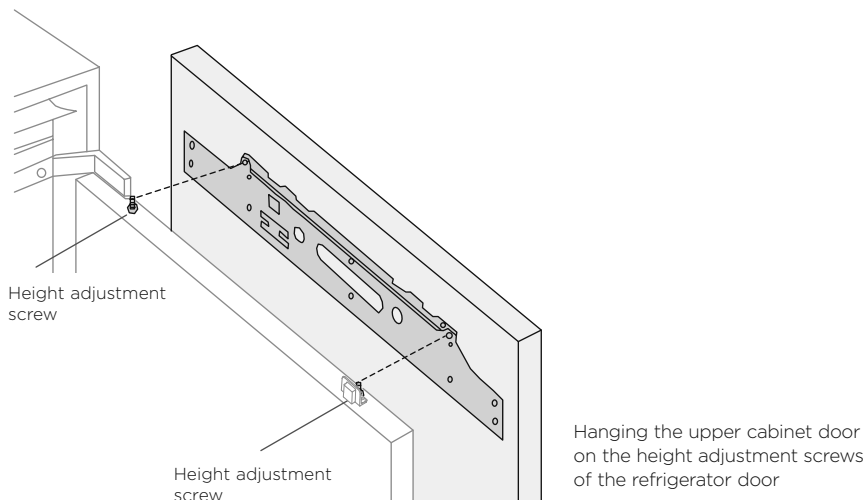

- ② Adjust cabinet doors as per the adjustment method (page 21). After adjustment use the bottom attachment brackets to fix the upper cabinet door to the refrigerator door.

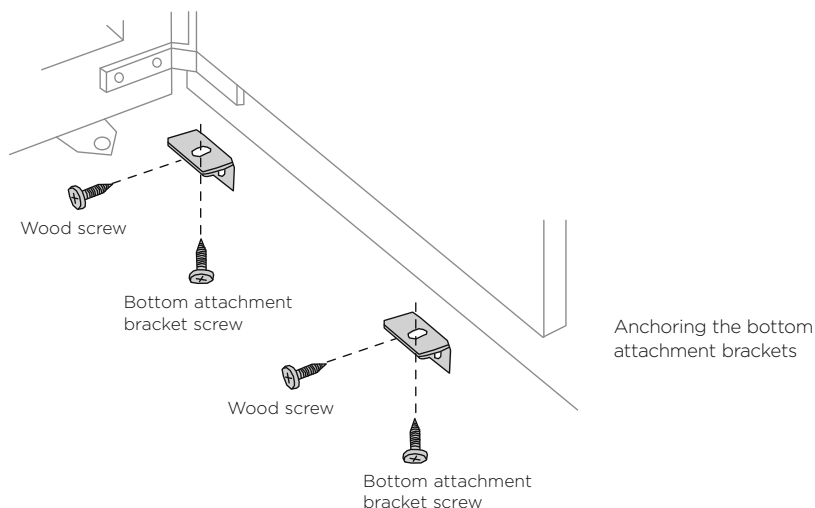

## 6. Attaching the top attachment bracket to the lower cabinet door

- ① Lay the lower cabinet door (face down) onto a clean floor.
- ② Attach the top attachment bracket to the top of the cabinet door.
- ③ Adjust to ensure the centre line of the top attachment bracket aligns with the centre of the cabinet door. The rulers should latch onto the top of the cabinet door.
- ④ Once aligned, screw the wood screws in to attach the top attachment bracket to the cabinet door.
- ⑤ Pull out the rulers on the top attachment bracket.

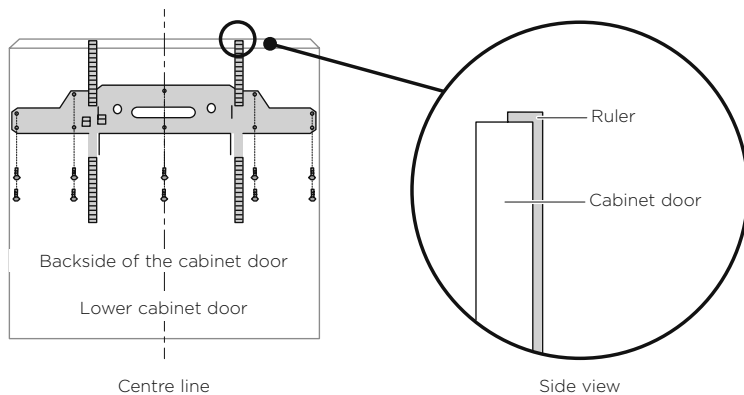

Attaching the top attachment bracket to the lower cabinet door

## 7. Attaching the lower cabinet door

- ① Open the freezer door, hang the cabinet door onto the height adjustment screws and fix with a hex screw.
  - Do not fasten the screws too tightly, allow for some horizontal movement of the cabinet door.

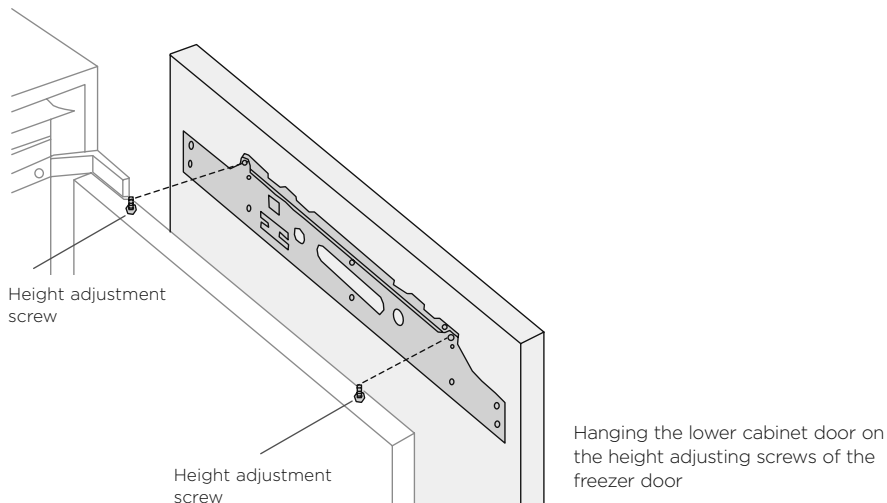

- ② Close the door, the screw should not be tightened. Adjust the left and right clearance of the upper end.
- ③ Adjust the cabinet doors as per the adjustment method (page 21). Then use the bottom attachment brackets to fix the lower cabinet door to the freezer door.

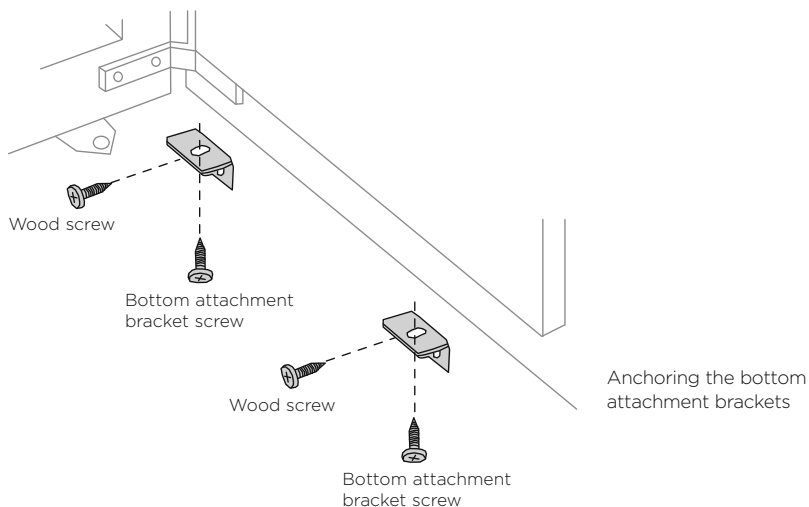

## 8. Top adjustment of the cabinet doors

### Height adjustment of the cabinet door

- ① Turn the height adjustment nuts (**A**) with a hex key.
- We recommend to use a T-handle hex key so that the height adjustment nuts can be turned easily without being blocked by the magnet sensor.
- If the height adjustment nuts cannot be adjusted, check the left and right clearances of the top hanging bracket.

### Side adjustment of the door panel

- ② Loosen the side adjustment nuts (**B**) and move the door panel slightly sideways to adjust the side alignment.
- We recommend to use socket spanner to loose or tighten the nuts N so that it can be turned easily without being blocked by the magnet sensor and cabinet door.

### Depth adjustment of the door panel

- ③ Loosen the depth adjustment nuts (**C**) and move the door panel forward/backward to adjust the depth position.
- ④ Tighten the nuts fully after you are satisfied with the adjustments.

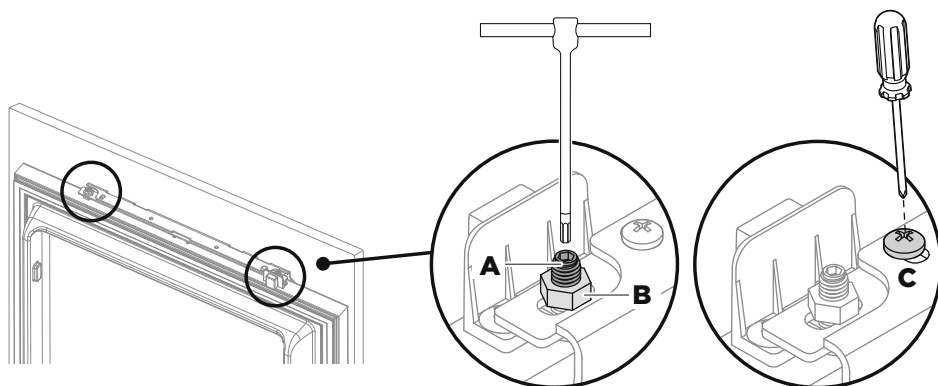

Adjusting top of cabinet door

**We recommend to use a socket spanner to loose or tighten the nut (A) in case of interference.**

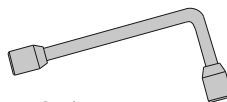

Socket spanner

## 9. Bottom adjustment of the cabinet doors

- ① Loosen the screws slightly, adjust the depth (**A**) and then tighten the screws.
- ② Insert the wood screws into the remaining holes in the bottom adjustment bracket after adjusting the horizontal positioning of the cabinet door.

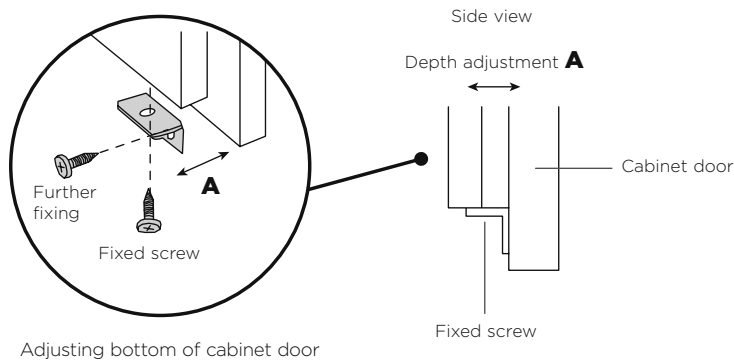

## 10. Finishing work

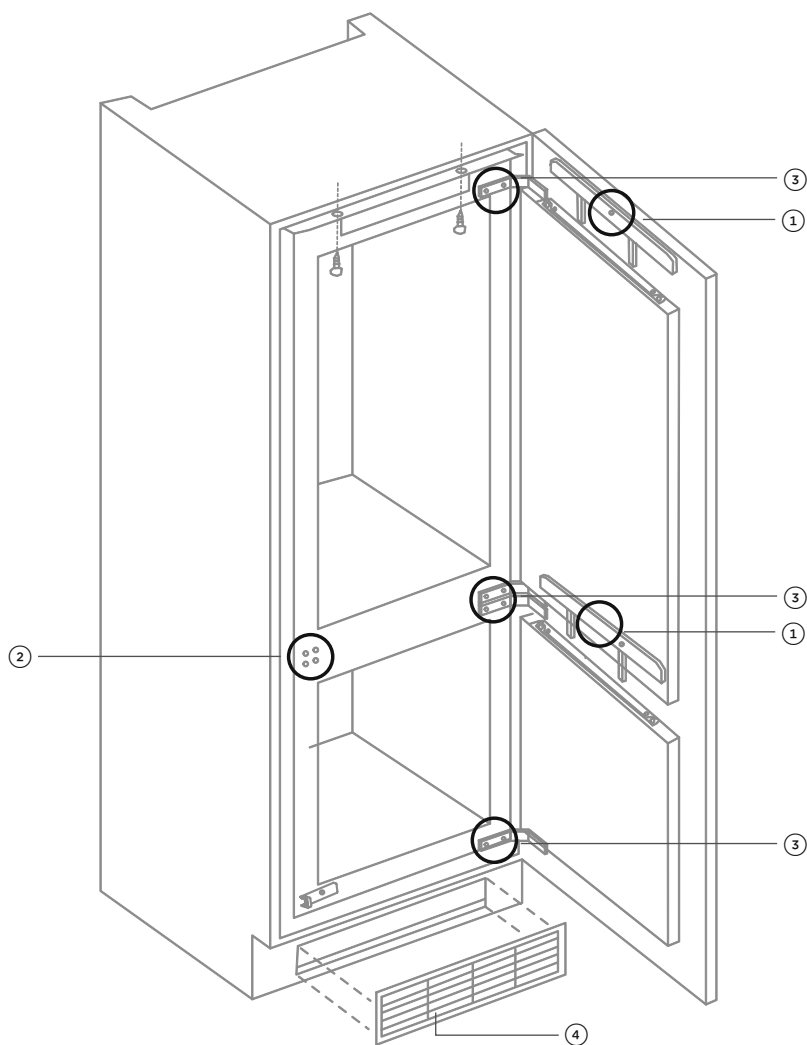

Positions of final adjustments

## INSTALLATION INSTRUCTIONS – REFRIGERATOR

- ① Insert the top adjustment bracket cover onto the top adjustment bracket (2 places, refer to **A**).

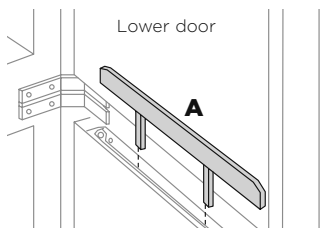
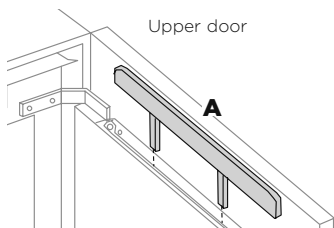

- ② When changing the hinge position, remember to insert hinge hole sheets (4 places, refer to **B**).
- For left-opening door, take off the hinge hole sheets and change the position of the hinge. Insert hinge hole sheets to the hinge fixing holes on the opposite side.

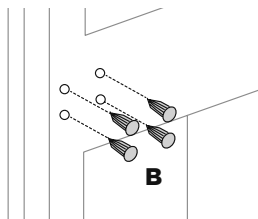

- ③ Insert the hinge cover (4 places, refer to **C**).

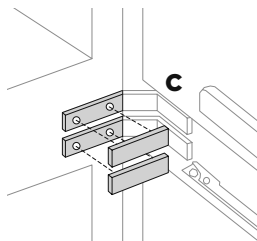

- ④ Install the ventilation grill at the kick strip section of the refrigerator cabinet (refer to **D**). Fix the ventilation grill into the kick strip.
- Grille can be purchased as an optional accessory. Go through spare parts (selected markets only) or your authorised retailer. Part number 873917.

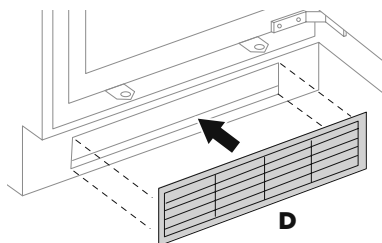



# INSTALLATION INSTRUCTIONS — REFRIGERATOR

## Components list — Trim kit installation

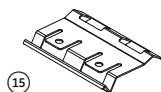

⑮  
Top trim clip  
H0060114628  
(2)

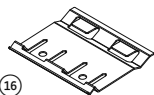

⑯  
Side trim clip  
H0060114629  
(8)

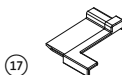

⑰  
Trim end LH  
H0060224901  
(2)



⑱  
Trim end RH  
H0060224901A  
(2)



⑲  
Screw  
H0130100516  
(20)

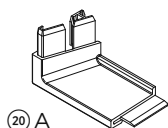

⑳ A  
Top corner  
non hinged RH  
H0060224899  
(1)

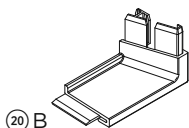

⑳ B  
Top corner  
non hinged LH  
H0060224899A  
(1)

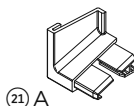

㉑ A  
Top corner  
hinged LH  
H0060224900  
(1)

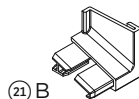

㉑ B  
Top corner  
hinged RH  
H0060224900A  
(1)



㉒  
Top trim  
H0060114625  
(1)



㉓  
Side trim bottom  
compartment  
hinged side  
H0060114626B  
(1)



㉔  
Side trim top  
compartment  
hinged side  
H0060114626A  
(1)



㉕  
Side trim non  
hinged side  
H0060114626  
(1)

# INSTALLATION INSTRUCTIONS – REFRIGERATOR

## Mounting the trim clips to the cabinetry

Attach brackets at 'Installation Instructions – Refrigerator', '1. Preparations before installation'.

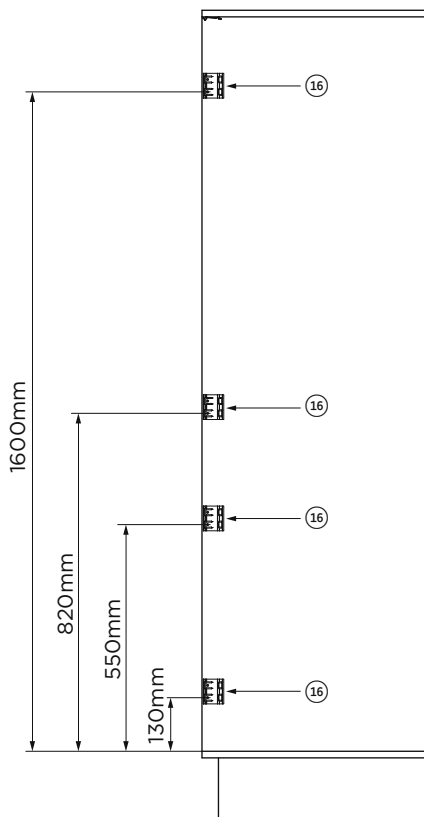
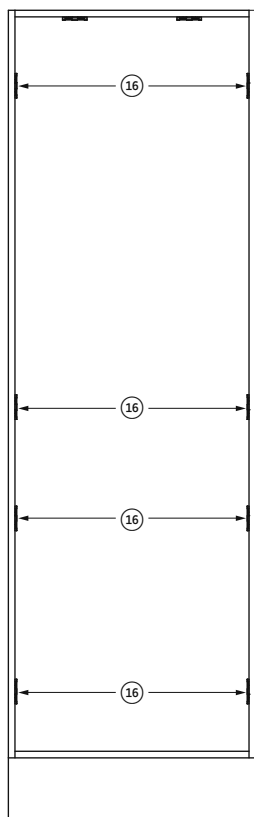
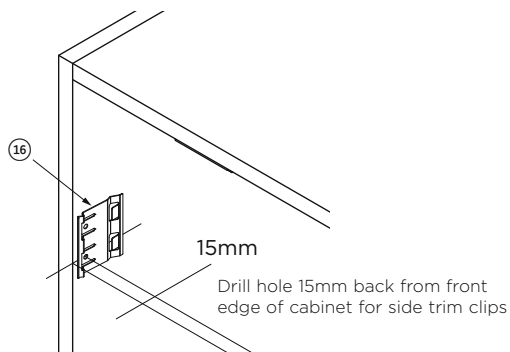
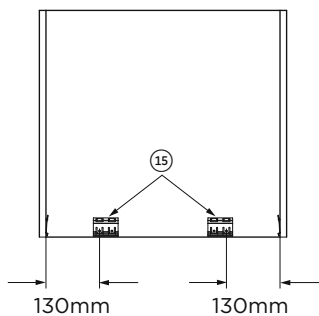

# INSTALLATION INSTRUCTIONS — REFRIGERATOR

## Installation of trim kit

Attach trims at 'Installation Instructions — Refrigerator', '10. Finishing work'.

Note: top trim (22) is correct length for cabinets with 16mm wall thickness. For 18mm wall thickness, 4mm will need to be cut off the top trim

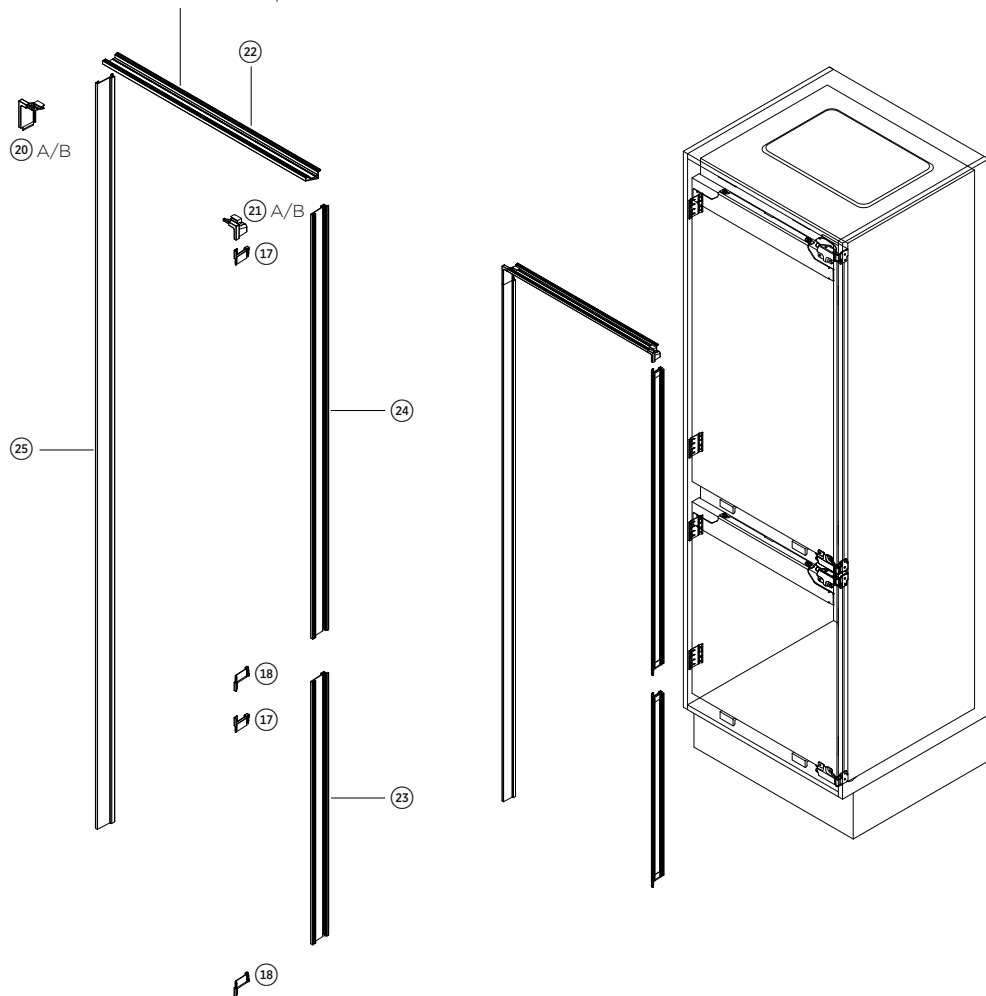

## MOVING OR STORING YOUR REFRIGERATOR

---

If your refrigerator is turned off for any reason, wait 10 minutes before turning it back on. This will allow the refrigeration system pressures to equalise before restarting.

### **Moving your refrigerator**

- Turn off the appliance by pressing the ① button for 3 seconds, turn it off at the wall and unplug it from the power point. Remove all food inside.
- Relocate and install. The inclination during transportation shall be less than 45° to ensure no damage to the cooling system occurs.

### **Storing your refrigerator**

- When storing your cleaned appliance, leave the door(s) open. This allows air to circulate and prevents the build up of bacteria and moulds.
- Before using again, clean well using a mixture of warm water and baking soda (add 1tsp of baking soda to each 500ml of water). Rinse with clean water.

### **Holiday time**

- We recommend you leave your refrigerator operating on 'Holiday Mode' (see page 32) while you are on holiday.
- For extended time away from home, remove all food and unplug the power plug. Clean the refrigerator and open all doors to ensure undesirable odours do not develop.